

Licensing Act 2003 Schedule 12 Part A

Regulation 33,34

Premises Licence

Premises Licence Number

15/00061/LAPRE

Part 1 – Premises Details

Postal address of premises, or if none, ordnance survey map reference or description, including Post Town, Post Code

Woody Express
103 The Parade
High Street
Watford
WD17 1LU

Telephone number

Where the licence is time limited the dates

From 2 March 2015

Licensable activities authorised by the licence and the times the licence authorises the carrying out of licensable activities

Late night refreshment	Monday to Saturday	23:00 – 04:00
	Sunday	23:00 – 01:00

The opening hours of the premises

Monday to Saturday	11:00 – 04:00
Sunday	11:00 – 01:00

Where the licence authorises supplies of alcohol whether these are on and / or off supplies

Not applicable

Part 2

Name, (registered) address, telephone number and email (where relevant) of holder of premises licence

Mr Cengiz Erpolat
103 The Parade
High Street
Watford
WD17 1LU

Registered number of holder, for example company number, charity number (where applicable)

Not applicable

Name, address and telephone number of designated premises supervisor where the premises licence authorises the supply of alcohol

Not applicable

Personal licence number and issuing authority of personal licence held by designated premises supervisor where the premises licence authorises for the supply of alcohol

Personal Licence Number: Not applicable
Licensing Authority: Not applicable

Annex 1 – Mandatory conditions

The following mandatory condition is only applicable should there be any condition attached to the licence which requires a member of door staff to be present at any time. If there are no such conditions attached to the licence, then there will be no mandatory conditions applicable:

1. Any individual employed on the premises to conduct a security activity (within the meaning of section paragraph 2(1)(a) of schedule 2 to the Private Security Industry Act 2001) must be licensed by the Security Industry Authority.

DRAFT

Annex 2 – Conditions consistent with the Operating Schedule

The following conditions are considered by officers to be consistent with the Operating Schedule submitted with this application, reference 15/00061/LAPRE:

1. All doors and windows shall be kept closed except for the immediate access and egress of persons
2. A notice shall be prominently displayed at the exit from the premises requesting patrons to respect the needs of local residents and leave the area quietly

DRAFT

Annex 3 – Conditions attached after a hearing by the licensing authority

The following conditions have been proposed in response to representations regarding this application, and have also been suggested by a responsible authority.

The inclusion of these conditions does not restrict the Sub-Committee's power to attach conditions from the licensing authority's pool of conditions (amended or otherwise) or to compose their own conditions if they consider that they are appropriate, proportionate, justifiable, and within the applicant's power to comply with.

1. No rubbish shall be moved, removed or placed in any external area between 23:00 and 07:00 on any day.
2. All litter, including food debris, which is associated with the use of the premises shall be cleared from within a 15 metre radius of the shop front at the close of business every day. All such rubbish to be disposed of as trade waste.
3. All customers shall be asked if they require a bag and serviettes for their food, and shall only be provided if required by the customer.
4. Notices shall be prominently displayed at all exits requesting patrons to respect the needs of local residents and leave the area quietly, and to dispose of their waste responsibly
5. A bin shall be provided for public use within the public area of the premises.
6. At least 1 SIA licensed door supervisor shall be on duty at the entrance of the premises whenever the premises is open to trade after 01:00. The door supervisor shall remain on duty until 30 minutes after the premises closes to the public.

Annex 4 – Plans

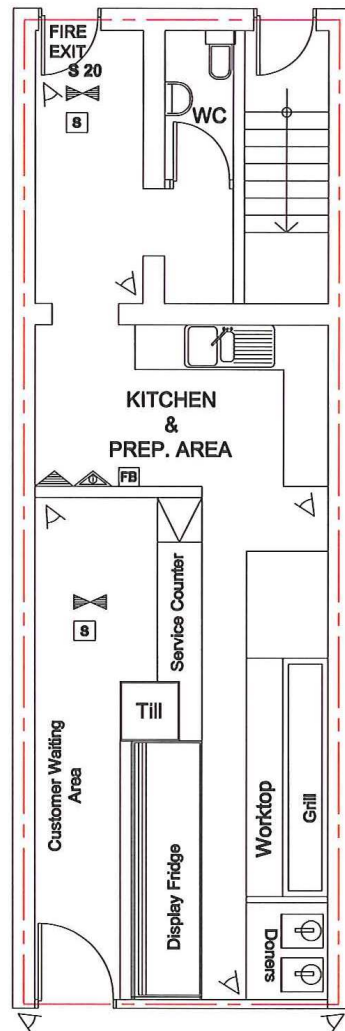

LEGEND

- WC AREA
- FRIDGE
- AMBIT OF LICENSED PREMISES
- SAFETY LIGHTS
- SMOKE DETECTOR
- CARBON DIOXIDE FIRE EXTINGUISHER
- 9 LT. WATER FIRE EXTINGUISHER
- FIRE ESCAPE KEEP CLEAR
- CCTV
- INTERNALLY ILLUMINATED FIRE ESCAPE SIGN (BS 5266)
- FIRE BLANKET
- FAN 6lt/s
- FIRE ALARM BELL
- FIRE DOOR
- FIRE SWITCH PANEL

THE PARADE
HIGH STREET



Alto
Design & Build Ltd

ARCHITECTURAL & ENGINEERING DESIGN
2 CHEAPSIDE, NORTH CIRCULAR ROAD
LONDON, N13 5ED
T: 0772 333 1891, 020 3213 0192
e-mail: alco@altoogroup.co.uk
www.altoogroup.co.uk

PROJECT : Premises Licence Application

DRAWING TITLE: Floor Plan

PROJECT ADDRESS : 103-105 The Parade,
High Street
Hertford, WD17 1LU

SCALE : 1:50 @ A4 DATE : Dec./2014

PROJECT No : CE14-01